

RCPNA General Meeting

January 26, 2016

German American Society

7 pm

Fifty-four (54) guests, invited speakers, and RCPNA Board Members were in attendance. Copies of the sign-in sheets are provided as an attachment.

Chair Tamara DeRidder convened the meeting at 7 p.m. She gave an overview of the meeting agenda and had RCPNA Board Members introduce themselves. She also thanked audience members who brought in donations of clothing and toiletries for local charities serving the homeless.

Neighborhood Police Officer Craig Anderson was ill. Meg Juarez, Crime Prevention Coordinator for the Office of Neighborhood Involvement, spoke briefly in his place. She noted that neighbors are posting information about crime to the online tool, NextDoor. She noted that NextDoor is a great resource but should not be used as a substitute for reporting a crime to the police. She noted that neighbors can report a crime to the police online. Juarez also noted that her colleague, Mark Wells, coordinates Neighborhood Watch groups. People who would like to be a part of or organize a Neighborhood Watch foot patrol can contact Mark to register their group and receive some training.

Chair DeRidder noted that Central Northeast Neighbors is sponsoring a viewing of a movie “MisLead” on February 29th at the Hollywood Theatre. It’s about the epidemic of lead poisoning in the U.S.

Later in the evening, Neighborhood Officer Johnson arrived and gave an update on crime in and around the neighborhood. He mentioned the traffic issues around Rose City Futsal (which are being addressed) and campers at Normandale Park (signs have been posted prohibiting overnight parking). He also reiterated the importance of reporting crimes and not simply posting on Next Door. The police nonemergency line can be called at 503-823-3333. He asked the audience for any concerns about crime and traffic, and several people mentioned traffic issues at intersections throughout the neighborhood.

Chair DeRidder introduced the first speaker, Portland City Commissioner Dan Saltzman. Commissioner Saltzman has been on the City Council for 16 years.

Saltzman described activities the bureaus he oversees are involved in:

- *Portland Fire Bureau*—Call volume is increasing, but the number of firefighters has not increased. Saltzman has been working with the Bureau to identify innovations to keep high levels of service while reducing costs. Seventy-five (75) percent of calls to PFB are medical in nature. Saltzman has been working with the Bureau to acquire Rapid Response Vehicles, two-person vehicles that can respond to low-level medical calls

without needing for a ladder truck to roll to the scene. Saltzman also noted that most fires occur in houses, where often there are no fire alarms and fire extinguishers. PFB can do a voluntary home-safety inspection. The program is being piloted in two station areas (downtown and Southwest Portland) for consideration for a city-wide rollout.

- *Bureau of Development Services*—The Bureau “makes city living possible,” according to Saltzman. The Bureau is busy with home construction and remodeling permits. It is funded by permit fees, so the funding is boom-and-bust. Right now the bureau is hiring staff. The Bureau also inspects rental properties. Tenants are often afraid to make claims, fearing eviction. The Bureau will send out inspectors to inspect apartments and require corrective actions where identified.
- *Portland Housing Bureau*—The booming housing market is causing rental challenges; there is a 2-3% vacancy rate in the Portland rental market, which is unusually low. Saltzman’s main goal when he took over the Bureau was to increase affordable housing. Not enough affordable housing units are being created, and affordable housing is a concern of the entire City Council. The Council increased the amount of money in urban renewal areas to be dedicated to affordable housing production. The city and Multnomah County have also put out requests for proposals for developers to create over 2,000 units of affordable housing. The city and the county have \$65 million and several pieces of property to dedicate to the effort. The bureau is also considering allowing “incentive zoning” where developers can increase the height or density of projects if they commit to building affordable units or pay into a housing investment fund. Saltzman also noted that Oregon law prohibits cities from using “inclusionary zoning” as a tool to increase affordable housing. The city is working with the Oregon Legislature to possibly change this. The Bureau has increased notification requirements for evictions and rent increases of over 5%. Mayor Hales has also asked all city bureaus to consider 5% budget cuts that will help fund affordable housing and housing services. The Bureau has policies to help prevent gentrification and/or help families that have been displaced by it.

Saltzman then took questions and comments from the audience, which included:

- The income levels for affordable housing programs (around \$22-24,000 a year for a single adult);
- Concerns about home demolitions (Saltzman and Mayor Hales supported a demolition tax but it did not pass; there is not much the city can do to prevent demolitions where owners or developers have followed all the rules);
- The duration and enforceability of density incentive programs (one program under consideration would require affordability requirements be in place for 60 years);
- Multnomah County re-assessing accessory dwelling units as new developments (the City Council has asked the County tax assessor to address this; the city has dedicated the lodging taxes charged from AirBnB rentals to affordable housing).
- Homelessness/camping; and

- Inclusionary zoning tax break potentially taking away tax revenues (Saltzman thinks developers need to do more to create affordable housing but the city needs to allow them to develop projects that will “pencil out”).

Donna Dorsey next spoke about NE Villages PDX. The concept of villages is to allow older adults to “age in place,” i.e., remain in their homes as long as possible with the assistance of volunteers. It’s a national movement that started in Boston. There is a village set up and running in Southeast Portland. Organizers are seeking to establish a village in Northeast Portland. Flyers with more information were distributed (see attachment), and it was mentioned that the group meets the second Wednesday of every month at 7 pm at Rose City Park United Methodist Church. The membership and pricing structures are still being developed. A fee would be charged to help coordinate volunteers, vet vendors, and run the administrative aspects of the program.

Next, RCPNA Board Members reported on the activities of various Committees.

- Communications (Erich Stiefvater) – The Committee is continuing to make improvements to the website, and has recently acquired a MailChimp account for email management and electronic newsletters. There are several vacancies among the newsletter delivery team. The deadline for the April newsletter will be March 10. People with articles or story ideas, or who would like help deliver newsletters, were encouraged to contact Erich using the contact information provided in the newsletter.
- Treasurer’s Report (Richard Crockett) – Richard gave a report on the RCPNA Budget for the calendar year 2015 (see attached). There was little activity over the winter months.
- Local Business (Deborah Lynn) – This new committee was formed at the end of last year. Its mission is to develop a stronger relationship between neighbors and local businesses in the Hollywood, Beaumont, and International District business associations. Committee members are going to these associations’ meetings and finding out how RCPNA can have a presence at events sponsored by the associations. Other outreach ideas being considered include email campaigns and coupon books.
- Clean-Up (Robert Coleman) – The 2016 Clean-Up and Yard Sale will be May 21 at Archbishop Howard School. Certain items cannot be accepted at the Clean-Up (more information will be available in the next newsletter).
- Land Use and Transportation (Tamara DeRidder) – The Committee is communicating with potentially affected neighbors around a revision to the Comprehensive Plan zoning map for the area around the 60th Avenue MAX station. The current map focuses density right around the MAX Station, which has led to concerns about future residents being negatively affected by air pollution from I-84 and freight train locomotives. The Committee is working with neighbors on a proposed change that would shift density away from the MAX station and up 60th Avenue towards Halsey. The Committee is also working with residents of the Euclid Heights Subdivision on a potential down-zoning, and with PBOT on transportation planning for Halsey and surrounding streets. These and other land use items will be discussed at the Committee’s next meeting at the

German American Society on February 18th at 7 pm. Tamara distributed flyers with information and details for the meeting (see attachment).

- Entertainment (Craig Lindsay) – The summer concerts will be on July 23 and 30. Talent has not yet been selected for the events, so attendees were invited to submit ideas or leads. In response to a question, Craig described how the money raised from the “passing of the hat” at the concerts is used (it goes into the RCPNA general fund to offset the costs of the concerts, which represent RCPNA’s single-largest annual expense).
- Emergency Preparedness (Craig Lindsay) – Craig is currently participating in the city’s Neighborhood Emergency Team training. He and co-chair Gail Zuro are identifying ways to organize events to connect neighbors to neighbors in order to prepare people for emergencies and to promote neighborhood resiliency. People interested in helping organize these events should contact Craig or Gail.
- Environment (David Gates) – David noted two upcoming events people can participate in: a neighborhood tree survey and the Friends of Trees spring planting. People interested in volunteering for either can contact David for more information. Neighbors who wish to use Friends of Trees to have a street or yard tree planted on their property will need to start the process by February 15.

Chair DeRidder next introduced Marc Jolin of the A Home for Everyone initiative at Multnomah County and Josh Alpert, policy director for Mayor Charlie Hales, who spoke about city and county efforts to address homelessness. They provided information and statistics about homelessness in Portland and efforts that are being made to help people move out of homelessness. Highlights included:

- The A Home for Everyone Initiative brings together government, private, philanthropic, and nonprofit agencies to coordinate efforts to respond to the crisis of homelessness. It has different subcommittees working on different facets of the crises (e.g., affordable housing, employment).
- An estimated 4,000 individuals in Portland are sleeping on the street or in emergency shelters every night (2,000 on the streets and 2,000 in shelters). An estimated 16,000 people in Multnomah County are experiencing problems with accessing and keeping stable housing.
- Initial successful efforts and activities have included:
 - Helping 695 homeless veterans obtain stable housing;
 - Converting two winter shelters to year-round shelters, creating 115 year-round beds for men and 130 spaces for families;
 - Creating a new outreach team to work with hard-to-engage homeless people;
 - Creating culturally appropriate services through Self-Enhancement Inc. and IRCO; and
 - Adding resources for homeless youth, in particular homeless youth parents.
- These investments have promoted an increase in the number of people accessing permanent housing from 3,000 people in 2013-2014 to 3,500 last year. A goal is to increase this number to 4,350, and to prevent another 1,000 people from becoming homeless.

- The city is reviewing its policies regarding homelessness, camping and enforcement and consulting with its legal staff regarding the feasibility and risk of different strategies.
- The city is focused on managing the population of people living outside until additional affordable housing becomes available and mediating between the homeless, neighborhoods, and businesses. The goal is to provide a “way station” while more indoor spaces are made available.
- One of the root issues of homelessness in Portland is that there are more people sleeping outside than we have inside space for. A goal is to house permanently as many people as possible as quickly as possible. Ending homelessness may not be achievable, but efforts will be made to stabilize the population that is sleeping outside and focus on addressing root causes.
- Homelessness is not a problem unique to Portland; other cities are experiencing it and are seeking out ways to address it. Homelessness may be more visible in Portland than in other cities, however. In addition, there may be more homeless in Portland because the surrounding suburbs do not have amount of quality of services the city can offer.
- The city is considering allowing organized camping, such as at Hazelnut Grove in the Overlook neighborhood, particularly if a camp is organized by an established nonprofit. Such camps would have permits or use agreements and good-neighbor agreements. Having organized camps would enable the city (particularly the police) to focus enforcement on unorganized and/or problematic camps.
- As part of Mayor Hales declaring a homeless emergency, 275 new shelter spaces were made available in Multnomah Village. The city is also conducting other experiments, including providing two storage units the homeless can use to store their belongings during the day.
- Alpert acknowledged that the city’s efforts have felt a little ad-hoc and have not always been communicated effectively.

Jolin and Alpert then took questions from the audience, which included:

- If changes to city policy would be more compassionate (the city is trying to be more consistent about if and when it will clear out camps and more proactive about identifying where campers can go if their camp is cleared);
- If a spike in crime that could be traced back to a city-sanctioned camp would create legal liabilities for the city (the city’s attorneys are investigating this);
- If successful strategies might cause more homeless to come to Portland (most of Portland’s homeless are from Portland or Oregon; most homeless were not intending to become homeless);
- If the city tries to connect the homeless to friends or family members back home who could take them in (outreach workers do try to re-connect the homeless with people who can help them back home, but funding, for example to buy bus tickets, has been a challenge; 2-1-1 and the Rose City Resource Guide are available to help connect the homeless to services);
- Why the Wapato Jail isn’t being used as a shelter (it would be prohibitively expensive and would effectively warehouse the homeless far from services); and

- If work is being done to help the homeless find jobs (that is one of the areas A Home for Everyone is looking at).

Chair DeRidder adjourned that meeting at 9:02 pm.

Attachments:

- "What is Northeast Village PDX?" flyer
- RCPNA Treasurer's Report
- RCPNA Calendar Year Financial Report
- RCPNA Public Meeting Notice Regarding Land Use Issues and Feb. 18 Land Use and Transportation Committee Meeting (2 pages)
- Meeting Sign-In Sheets (4 pages)



What Is Northeast Village PDX?

Neighbors Helping Neighbors Age in Place

A group of Northeast Portland residents is working to create a membership organization that will allow seniors in the neighborhoods we serve to stay in their own homes as long as they can, at the least cost possible. Our purpose is to extend members' independence and autonomy by developing a network of engaged seniors and volunteers of all ages.

HOW IT WORKS

The village operates by bringing services to people rather than moving people to services. Examples include: help with yard work, rides to medical appointments and the grocery store, simple home repair, and assistance using computers and other electronic devices.

PART OF A LARGER MOVEMENT

As boomers age, they are increasingly taking charge of their senior years. The village exemplifies this spirit of self-sufficiency. The first village – Beacon Hill in Boston – began in 2002 with 12 older adults. It now serves 400 households in several Boston neighborhoods. Nationally, there are now over 190 villages up and running and 185 more in development.

WHEN AND WHERE WE WILL OPERATE

Northeast Village PDX is one of seven being developed in the Portland area. It will encompass 18 neighborhoods stretching from the Columbia River to I-84 and from NE 15th to NE 122nd. We plan to begin delivering volunteer and reduced-cost professional services, such as plumbing, electrical, and home health care, to members in autumn of 2016 to supplement existing community resources.

JOIN US

If you love your neighborhood and want to stay in your home, living independently for as long as possible, join us to build our village. Here's how to get involved:

- o Contact Margaret Baldwin at nevillagepdx@gmail.com or 503-895-2750.
- o Come to a Northeast Village PDX planning meeting at the Rose City park United Methodist Church, 5830 NE Alameda, 7 pm on the second Wednesday of the month.

For more information:

- o visit our website – <http://nevillagepdx.org>
- o learn about the larger village project in the Portland area at <http://villagesnw.org>
- o watch a good video about villages at <http://tedxboston.org/speaker/willett>

RCPNA Treasurer's Report

Rose City Park Neighborhood Association					
Treasurer's Report					
January 24, 2016					
Beginning Balance on 11/26/2015:					\$6,838.47
Number	Date	Name	Reason	Amount	Balance
	30-Nov	interest		\$0.37	\$6,838.84
	31-Dec	interest		\$0.30	\$6,839.14
		Ending balance on 1/24/2016			\$6,839.14

RCPNA details summary for calendar year 2015

Date	Ck Num	Description	Memo	Category	Deposit deta	Amount
		Balance on 1 Jan 2015				\$8,207.14
26-Jan		Newsletter ad	Steve Thomson Architect, 4 issues	Newsletter	Ck #203	\$126.00
30-Jan		Interest		Misc. Services		\$0.34
9-Feb	2196	domain name - 2 yr	eNom Inc.	Communications		-\$27.90
9-Feb	2197	Web hosting	Dream Host Web Hosting - 12 mo.	Communications		-\$119.40
9-Feb	2198	Newsletter printing	Community Newspapers	Newsletter		-\$755.00
18-Feb	2199	Genl Meeting food	Richard Crockett -- pizzas for 1/27	Food		-\$65.00
27-Feb		Interest		Misc. Services		\$0.30
20-Mar	2200	Graduation party donation	Madison PTSA Mad. Grad	Awards		-\$250.00
20-Mar	2201	Graduation party donation	Grant High School All-Night Party	Awards		-\$250.00
31-Mar		Interest		Misc. Services		\$0.32
16-Apr	2202	Clean-up flyers	Erich Stiefvater	Clean-Up		-\$152.25
23-Apr	2203	date stickers for signs	Bob Cynkar	Clean-Up		-\$95.79
28-Apr	2204	genl meeting music	Norman Sylvester	Entertainment		-\$125.00
30-Apr		newsletter ad	Portland Mutt Strut	Newsletter	Mutt Strut	\$126.00
30-Apr		history book sale	4/28 general meeting	History Book		\$25.00
30-Apr		Interest		Misc. Services		\$0.29
4-May	2205	Newsletter printing	Community Newspapers	Newsletter		-\$755.00
14-May	2206	State filing	Corporation Division	Misc. Services		-\$50.00
14-May	2207	change for Clean-Up	Richard Crockett	Clean-Up		-\$200.00
18-May		Clean-Up proceeds		Clean-Up		\$4,866.57
21-May	2208	intersection painting	Joey Razzano	Awards		-\$250.00
21-May	2209	food for Clean Up	Jo Schaefer	Clean-Up		-\$143.43
31-May		Interest		Misc. Services		\$0.32
1-Jun	2210	In-Fill Expo sponsorship	CNN	Awards		-\$250.00
1-Jun		metals \$211.00; other \$58.00		Clean-Up		\$269.00
2-Jun	2211	intake form printing	Richard Crockett	Clean-Up		-\$39.00
3-Jun	2212	posters	Erich Stiefvater	Clean-Up		-\$36.75
11-Jun	2213	food for In-Fill Expo	Barb Brunkow	Reserve		-\$80.11
30-Jun		Interest		Misc. Services		\$0.44
7-Jul	2214	Yard debris fee from clean-up	CNN	Clean-Up		-\$234.00
7-Jul	2215	Concert posters	Erich Stiefvater	Concerts		-\$27.00
7-Jul	2216	General meeting food	Ramona Reule	General Meeting food		-\$12.00
8-Jul		Community Partner	German Ladies Relief Society	Community Partners		\$500.00
8-Jul		Golf tournament sponsor	Rose City Cemetery	Golf tournament		\$350.00
8-Jul		Golf tournament sponsor	Fleur de Lis Bakery	Golf tournament		\$200.00
8-Jul		Donation	From In-Fill Expo	Misc. Services		\$4.75
14-Jul	2217	Newsletter printing	Community Newspapers	Newsletter		-\$755.00
14-Jul	2218	Walker Award-Richardson	Bob Richardson	Awards		-\$100.00
14-Jul	2219	Walker Award-Stovel	Linda Stovel	Awards		-\$100.00
16-Jul	2220	July 18 concert	Norman Sylvester Sr.	Concerts		-\$1,300.00
16-Jul	2221	stage rental for concerts	Drew Dannhorn	Concerts		-\$100.00
17-Jul	2222	Walker Awards 2015	Bardy Trophy	Awards		-\$101.90
17-Jul		Golf tournament sponsor	Van Tin Jewelry	Golf tournament		\$200.00
17-Jul		Golf tournament greens fees	Foley	Golf tournament		\$520.00
17-Jul		Golf tournament greens fees	Childs	Golf tournament		\$260.00
17-Jul		Golf tournament greens fees	Stetson	Golf tournament		\$260.00

RCPNA details summary for calendar year 2015

17-Jul		Golf tournament greens fees	Roth	Golf tournament		\$130.00
18-Jul	2223	Golf tournament	Rose City Park Golf Course	Golf tournament		-\$1,440.00
18-Jul	2224	Golf tournament proceeds	Hank Childs	Golf tournament		-\$1,240.00
20-Jul		Golf tournament greens fees	McKirdle	Golf tournament		\$130.00
20-Jul		Golf tournament greens fees	Anderson	Golf tournament		\$260.00
20-Jul		Golf tournament greens fees	Roth	Golf tournament		\$170.00
20-Jul		July 18 pass the hat half		Concerts		\$200.00
25-Jul	2225	July 25 concert	Tony Starlight	Concerts		-\$1,000.00
25-Jul	2226	Sound equipment rental	Larry Wilder	Concerts		-\$100.00
25-Jul	2227	portapotties, permits	Craig Lindsey	Concerts		-\$876.44
27-Jul		July 25 pass the hat half		Concerts		\$208.00
27-Jul	2228	bags for plastics	Michael Roth	Clean-Up		-\$20.00
31-Jul		Interest		Misc. Services		\$0.42
31-Aug		Interest		Misc. Services		\$0.31
4-Sep		CNN	newsletter support	Newsletter		\$2,200.00
10-Sep	2229	Mollie Altman	Retreat catering prepayment	Retreat		-\$162.50
12-Sep	2230	Mollie Altman	Retreat catering final payment	Retreat		-\$162.50
30-Sep		Interest		Misc. Services		\$0.36
12-Oct	2231	Keith Buckley	General Membership meeting	Entertainment		-\$100.00
30-Oct		Interest		Misc. Services		\$0.37
3-Nov	2232	Craig Lindsey	Picnic In the Park electric permit	Concerts		-\$54.00
3-Nov	2233	Ramona Reule	postage and raffle tickets	Communications		-\$82.49
15-Nov	2234	Oregon Department of Justice	2014 CT-12	Misc. Services		-\$10.00
15-Nov	2235	Community Newspapers	newsletter printing	Newsletter		-\$755.00
30-Nov		Interest		Misc. Services		\$0.37
31-Dec		Interest		Misc. Services		\$0.30
		Balance on 31 Dec 2015				\$6,839.14
		Summary				\$8,207.14
		Awards -- 6 awards (2 HS grad, intersection paint, In-Fill Expo; 2 Walker)		-1,301.90	-1,301.90	
		Clean-Up	5,135.57	-921.22	4,214.35	
		Communications		-229.79	-229.79	
		Community Partners	500.00		500.00	
		Concerts	408.00	-3,457.44	-3,049.44	
		Entertainment -- 2 general meetings		-225.00	-225.00	
		General meeting food -- 2 meetings		-77.00	-77.00	
		Golf tournament -- expenses + donation	2,480.00	-2,680.00	-200.00	
		History book	25.00		25.00	
		Misc. services -- interest, donation and State mandated filings	8.89	-60.00	-51.11	
		Newsletter -- CNN support, ads, printing	2,452.00	-3,020.00	-568.00	
		Reserve -- In-Fill Expo food		-80.11	-80.11	
		Retreat		-325.00	-325.00	
			11,009.46	-12,377.46		
		Net		-1,368.00	-1,368.00	
						\$6,839.14
						\$6,839.14

FEB 18th

RCPNA Public Meeting Notice

Contact Tamara DeRidder, RCPNA Chair, if questions. 503-706-5804 or TDR@tdridder.users.panix.com

On Thurs. Jan. 21st the Land Use & Transportation Committee (LU & TC) for Rose City Park Neighborhood Association (RCPNA) will be holding a public meeting to discuss three items that may affect your property. The LU & TC will be meeting on Jan. 21st from 7:00 – 9:00 pm at the German-American Society, 5626 NE Alameda. The topics to be discussed are as follows:

1. 5325 NE Irving proposal to build 7-condos on property currently containing one residential home.
2. Provisional Comprehensive Plan Map Amendment for Euclid Heights Subdivision Down-Zone from R2.5 to R5 and Redesign of the NE 60th Ave. Station Area Plan.
 - a. PBOT Planner Zef Wagner to provide an overview of planned transportation improvements for the Station Area;
 - b. Identify & discuss improvements needed and options for funding; and
 - c. Next Steps for outreach and public involvement for February 18th LU & TC meeting.

What: LU & TC Meeting, open to the public
When: Thurs. Jan. 21st from 7:00 – 9:00 pm
Where: German-American Society, 5626 NE Alameda St., 97213

Note: On Feb. 18th the LU & TC will hold their final meeting on these Provisional Amendments at the same time and location.

Provisional Map Amendment for discussion: Euclid Heights Subdivision Down-zone to R5

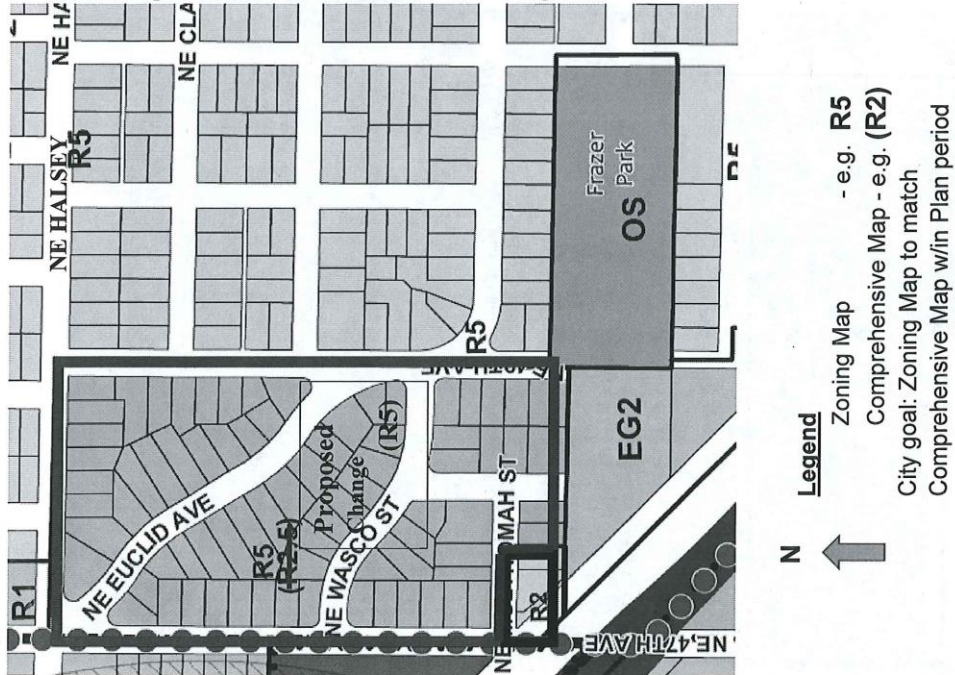

Resources: Single-Dwelling Zones, see: <https://www.portlandoregon.gov/bps/article/53295>
Multi-Dwelling Zones, see: <https://www.portlandoregon.gov/bps/article/53296>

W. O. / O. O. H.

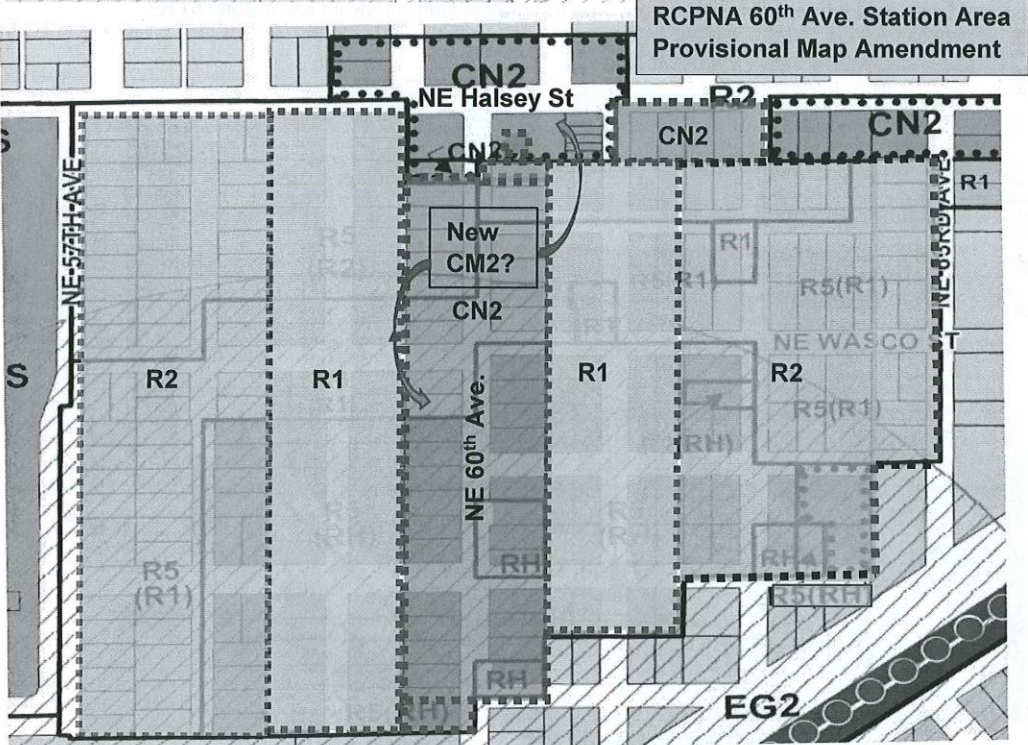
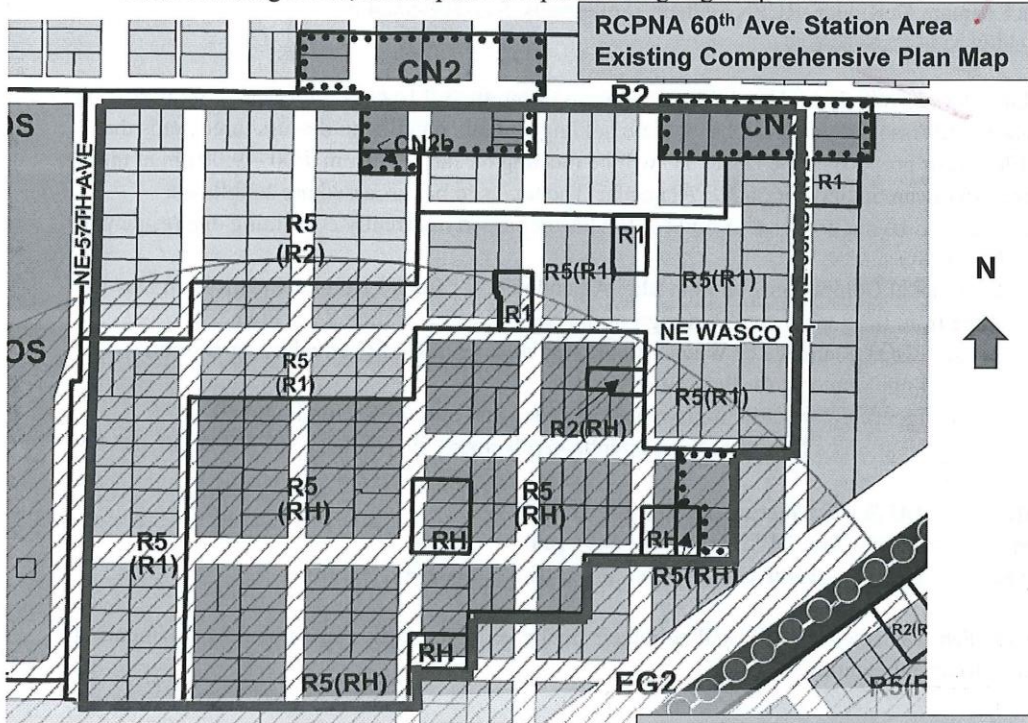

Resources: Mixed Use Commercial, see: <http://www.portlandoregon.gov/bps/article/532450>